

# Fitting the 40/80 Zone LED Expansion Kits

The 40-zone LED Expansion Kit or the 80-zone LED Expansion Kit includes the following:

- 1x Zone LED PCB (40 zone or 80 zone)
- 1x 26-way Ribbon cable
- 6 x 3mm screws.
- Fitting instructions



Take suitable anti-static precautions before carrying out this procedure.



Make the panel safe before carrying out either procedure described below. Isolate and disconnect the mains supply. Disconnect the batteries.

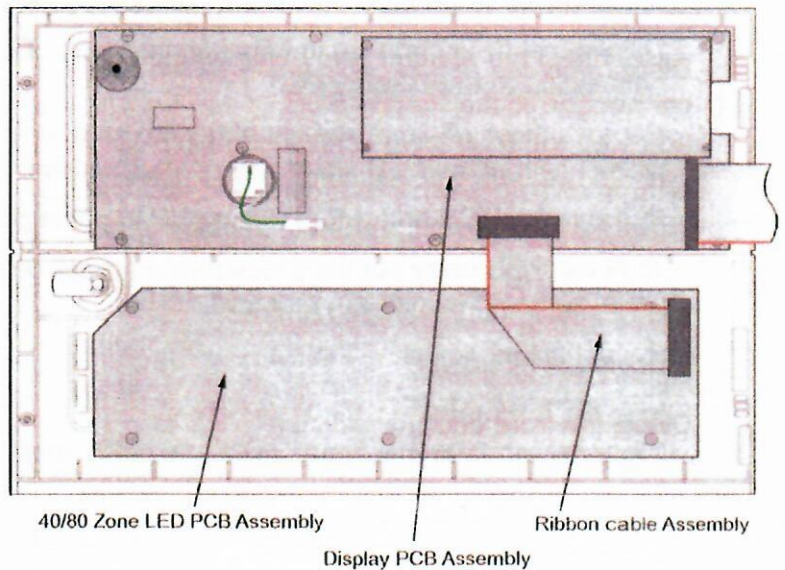

## 1 Introduction

- The procedure is the same whether fitting the 40-zone LED Expansion Kit or the 80-zone LED Expansion Kit. These instructions describe the fitting of either Zone LED Expansion Kit option.

### 1.1 Procedure

- Open the front door and locate the lower space which will house the zone expansion PCB.
- With the PCB correctly orientated (see drawing above) offer the PCB to the six stand-offs on the door. Secure the PCB to the door using the six 3mm screws. Do not overtighten.
- Connect the ribbon cable between the zone expansion PCB and the connector SK1, located on the lower edge of the Display PCB (refer to drawing above).
- Bend the end of the zone text labels, along the scoring, through 90° before inserting them. Zones 1-40 go in the top slot (A) and zones 41-80 (or blank if 40 zone PCB is being fitted) goes in the bottom slot (B).
- Reconnect power to the panel.
- To avoid a fault indication, the panel settings must now be updated to add the zone LEDs. From the Commission menu (access Level 3 passcode required) select '1: General Options'. Locate the Zone LEDs option and change the status to 'YES'. Exit from the Commission menu. The setting is saved on exiting this menu.

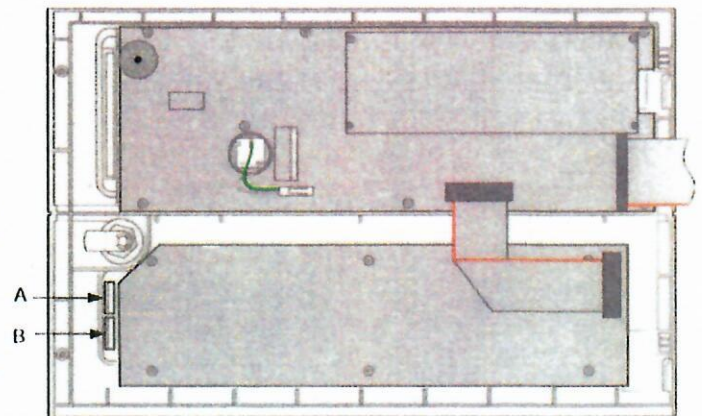

**Note:** The 'Zone LEDs fitted' status can also be set using the PC tool.

---

## 2 PCB Replacement

- Remove all power from the panel before carrying out this procedure. Once mains power has been disconnected, open the front door to access the battery connections and disconnect them.
- Disconnect the ribbon cable between the zone LED PCB and Display PCB. Leave the cable connection to the Display PCB.
- Remove the 6 off 3mm screws and keep safe for fitting the replacement PCB (the PCB is supplied with its own screws). Discard any surplus screws.
- Remove the PCB and return to supplier in packaging used by replacement PCB.
- To fit the PCB carry out the procedure on previous page. However, as this is a replacement PCB no panel setting changes are required.
- Reconnect all power.
- Close the front door.
- If any related fault messages exist, press the reset key to clear them.